

# DIGITAL RTJ RING GROOVE CALIPERS

DATA  
OUTPUT

- Measure ring grooves of flange
- Resolution: 0.01mm/0.0005"
- Button function: on/off, set, zero, mm/inch, data preset
- Battery CR2032, data output
- Made of stainless steel
- Optional accessory: data output cable (code 7315-, 7302-, 7305-, for calipers without built-in wireless)



1179-300

1179-300  
preset buttons



1179-600

measure outside diameter  
of RTJ ring groove

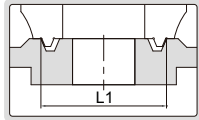

measure inside diameter  
of RTJ ring groove

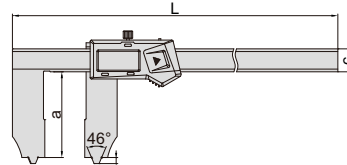
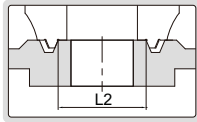

Type A

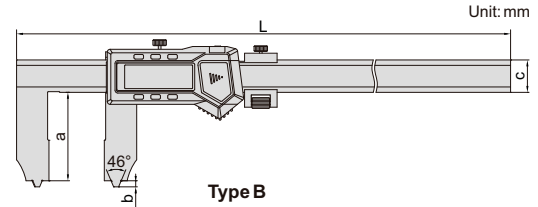

Type B

(mm)

Code	L	a	b	c	d	e
1179-300	410	63.5	4.5	17	25	10
1179-300WL						
1179-600	770	65.5	4.5	24	25	10
1179-600WL						
1179-1000	1220	90	5	31	30	15

applicable for RTJ ring  
grooves with angle 23°

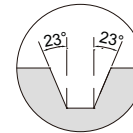

d and e need to  
be added on the reading

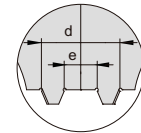

Code	Range (inside diameter of RTJ ring groove)	Range (outside diameter of RTJ ring groove)	Angle of RTJ ring groove	Accuracy	Type	Wireless
1179-300	10-300mm/0.4-12"	25-300mm/1-12"	23°	±0.06mm	A	no
1179-300WL						built-in wireless
1179-600	10-600mm/0.4-24"	25-600mm/1-24"	23°	±0.07mm	B	no
1179-600WL						built-in wireless
1179-1000	15-1000mm/0.6-40"	30-1000mm/1.2-40"	23°	±0.09mm	B	no