

GP..02-MG | Medium Grooving

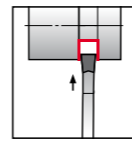
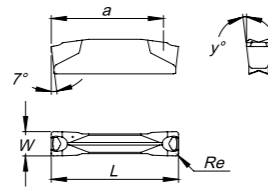

(1) Geometry code	ISO/ANSI Reference	P			M			K			N		S	Dimensions (mm)						Cutting Conditions		
		CVD-MT		PVD	CVD-MT		PVD	UNC	CVD-MT		UNC	PVD	W	Re	L	x°	a	y°	Seat ² Size	fn (mm/r)	Min	Max
		L8	N2	G4	L8	N2	G4	25	L5	L6	N2	10										
1130398	GP0300B020-N02-MG	Ⓜ		Ⓜ	Ⓜ						Ⓜ		3,0	0,2	21,0	-	18,5	6,5	B	0,06	0,05	0,10
1130399	GP0400C040-N02-MG	Ⓜ		Ⓜ	Ⓜ					Ⓜ		4,0	0,4	21,0	-	18,5	6,5	C	0,08	0,05	0,15	
1130400	GP0500D040-N02-MG	Ⓜ		Ⓜ	Ⓜ					Ⓜ		5,0	0,4	21,0	-	18,5	6,0	D	0,13	0,05	0,25	

Ⓜ First choice | Primeira opção | 1ª opción Ⓜ Stock item | Produto de stock | Itens de stock ○ Available under request | Disponível sobre consulta
 2 - Correspond to a Specific Holder

Insert order code = (1) Geometry Code + (2) Grade Code
 In some positions new grade PH7920, will be available when PH7325 stock ends.

GP..02-MM | Medium Multi Function

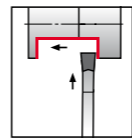
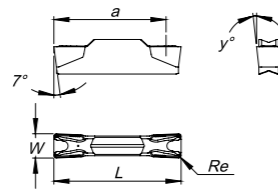

(1) Geometry code	ISO/ANSI Reference	P			M			K			N		S	Dimensions (mm)						Cutting Conditions					
		CVD-MT		PVD	CVD-MT		PVD	UNC	CVD-MT		UNC	PVD	W	Re	L	x°	a ¹	y°	Seat ² Size	Ap (mm)	Min	Max	fn (mm/r)	Min	Max
		L8	N2	G4	L8	N2	G4	25	L5	L6	N2	10													
1130401	GP0300B040-N02-MM	Ⓜ		Ⓜ	Ⓜ						Ⓜ		3,0	0,4	21,0	-	18,5	6,0	B	0,8	0,4	1,5	0,09	0,05	0,12
1130402	GP0400C040-N02-MM	Ⓜ		Ⓜ	Ⓜ					Ⓜ		4,0	0,4	21,0	-	18,5	6,0	C	1,1	0,6	2,0	0,12	0,07	0,15	
1130403	GP0500D040-N02-MM	Ⓜ		Ⓜ	Ⓜ					Ⓜ		5,0	0,4	21,0	-	18,5	5,5	D	1,5	0,8	2,5	0,14	0,10	0,18	

Ⓜ First choice | Primeira opção | 1ª opción Ⓜ Stock item | Produto de stock | Itens de stock ○ Available under request | Disponível sobre consulta
 1 - When using inserts with 1 Cutting edge, the "a" measure is given by the Toolholder | 2 - Correspond to a Specific Holder

Insert order code = (1) Geometry Code + (2) Grade Code

GP..02-MP | Medium Profiling

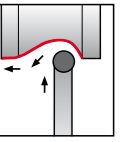
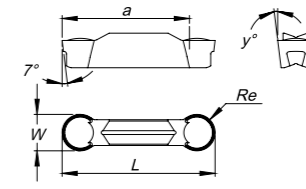

(1) Geometry code	ISO/ANSI Reference	P			M			K			N		S	Dimensions (mm)						Cutting Conditions					
		CVD-MT		PVD	CVD-MT		PVD	UNC	CVD-MT		UNC	PVD	W	Re	L	x°	a	y°	Seat ² Size	Ap (mm)	Min	Max	fn (mm/r)	Min	Max
		L8	N2	G4	L8	N2	G4	25	L5	L6	N2	10													
1130404	GP0600E300-N02-MP	Ⓜ		Ⓜ	Ⓜ						Ⓜ		6,0	3,0	25,2	-	21,0	7,0	E	1,50	0,04	2,20	0,18	0,15	0,22

Ⓜ First choice | Primeira opção | 1ª opción Ⓜ Stock item | Produto de stock | Itens de stock ○ Available under request | Disponível sobre consulta
 2 - Correspond to a Specific Holder

Insert order code = (1) Geometry Code + (2) Grade Code

GP..02-NP | Non-Ferrous Profiling

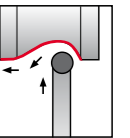
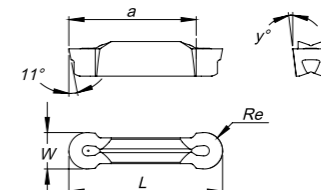

(1) Geometry code	ISO/ANSI Reference	P			M			K			N		S	Dimensions (mm)						Cutting Conditions					
		CVD-MT		PVD	CVD-MT		PVD	UNC	CVD-MT		UNC	PVD	W	Re	L	x°	a	y°	Seat ² Size	Ap (mm)	Min	Max	fn (mm/r)	Min	Max
		L8	N2	G4	L8	N2	G4	25	L5	L6	N2	10													
1130405	GP0600E300-N02-NP										Ⓜ		6,0	3,0	25,4	-	18,5	7,0	E	1,30	0,50	2,50	0,20	0,15	0,25

Ⓜ First choice | Primeira opção | 1ª opción Ⓜ Stock item | Produto de stock | Itens de stock ○ Available under request | Disponível sobre consulta
 2 - Correspond to a Specific Holder

Insert order code = (1) Geometry Code + (2) Grade Code