

# CENTER & CHAMFER

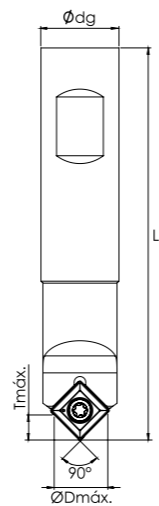

Order code Código	Reference Referência Referencia	⊕	Dimensions   Dimensões   Dimensiones (mm)					Kg	Insert Pastilha Inserto	Stock
			ØMáx.	Tmáx.	Ødg	L	Angle °			
181147400	CHT S16H N11-45	1	13	6,5	16	100	45	0,146	SOMT 11T308	☉
181147500	CHT S16M N11-45	1	13	6,5	16	150	45	0,180	SOMT 11T308	☉

Order code Código	Designation Designação Designación	Nº Toolholder	Holder designation	Nº inserts	Insert Pastilha Inserto	Stock
1410286G4	PK SOMT 11T308 CHTS16H	1	CHT S16H N11-45	10	SOMT 11T308	☉
1410287G4	PK SOMT 11T308 CHTS16M	1	CHT S16M N11-45	10	SOMT 11T308	☉

☉ Stock item | Produto de stock | Itens de stock

○ Available under request (see page A-6) | Disponível sobre consulta (consulte a página A-6) | Disponible bajo consulta (mire pagina A-6)

## SOMT 11T308... | Inserts | Pastilhas | Plaquetas

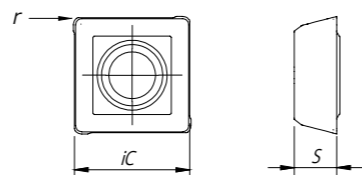

Geometry code (1)	ISO Reference	P						M				K				N		S		H	Dimensions Dimensões Dimensiones (mm) iC S l r F								
		CVD		PVD				CVD		PVD		CVD		PVD		UNC	PCD	CVD	PVD	PVD									
		T9	P7	G1	G4	P3	G6	R1	G4	P3	G6	L5	L6	L9	G1	G4	P3	G6	10	D6		R1	P3	G6	P7				
1112425	SOMT 11T308																								10,87	3,97	11,00	0,80	-

☉ First choice | Primeira opção | 1ª opción

☉ Stock item | Produto de stock | Itens de stock

○ Available under request (see page A-7) | Disponível sobre consulta (consulte a página A-7) | Disponible bajo consulta (mire pagina A-7)

Insert order code = (1) Geometry Code + (2) Grade Code

# Center & chamfer SOMT

## TOOL SELECTION | Selecção de ferramenta | Selección de herramienta

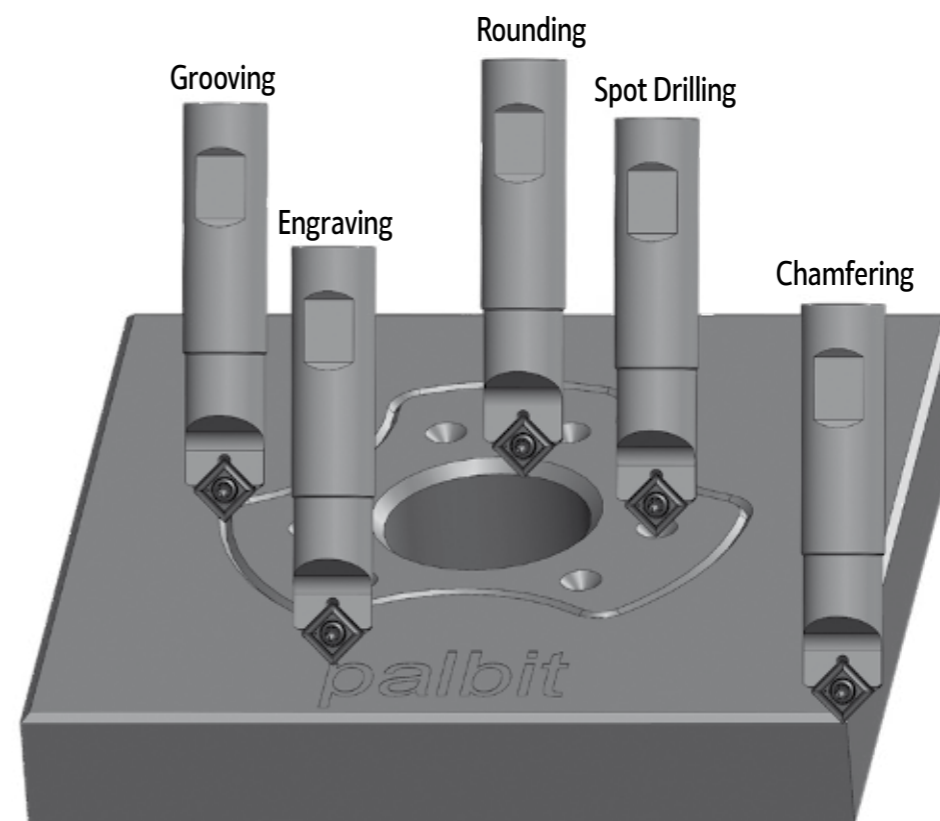

## SPARE PARTS | Complementos | Repuestos

Cutter ØDc	Order separately			
	Insert Screw	Key (Torx)	Key (Torx - Nm)	Torque Value
CHT S16...	P0350800	XT15	DT1530	3,0

Note: The toolholder is supplied with the XT/PT key. To order the DT key please check the page A-243. Check the procedures for the clamping screws on the page A-243.

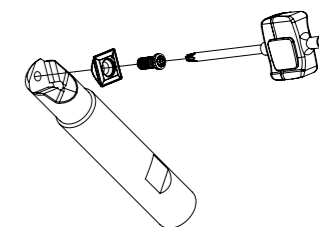

## RECOMMENDED CUTTING CONDITIONS | Condições de corte recomendadas | Condiciones de corte recomendables

ISO	PSM	Material	HB (Brinell)	Vc (m/min)	Feed fz (mm/t)
				PH7920	SOMT 11T308
P	1	Unalloyed Steel	125-220	120-150	0,04-0,08
	2	Low-Alloyed Steel	220-280	100-120	0,03-0,07
	3	High-Alloyed Steel	280-380	60-100	0,03-0,06
M	4	SS - Ferritic / Martensitic	200-330	100-150	0,04-0,07
	5	SS - Austenitic	200-330	80-120	0,03-0,06
	6	SS - Austenitic-ferritic (Duplex)	230-260	50-90	0,03-0,06
K	7	Malleable Cast Iron	130-230	90-150	0,05-0,10
	8	Grey Cast Iron	180-245	80-120	0,05-0,08
	9	Nodular Cast iron	160-250	70-110	0,04-0,08