

WWK

Woodruff

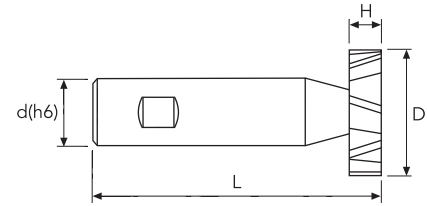

★ 1st choice ☆ suitable



D(h11)	D Tol.	d(h6)	H(e8)	H Tol.	L	z	EDP No.	Stock
10.5	0/-0.110	6	2	-0.032/-0.059	50	8	WWK105A	●
10.5	0/-0.110	6	2.5	-0.032/-0.059	50	8	WWK105B	●
10.5	0/-0.110	6	3	-0.032/-0.059	50	8	WWK105C	●
13.5	0/-0.110	10	2	-0.032/-0.059	56	8	WWK135A	●
13.5	0/-0.110	10	2.5	-0.032/-0.059	56	8	WWK135B	●
13.5	0/-0.110	10	3	-0.032/-0.059	56	8	WWK135C	●
13.5	0/-0.110	10	4	-0.032/-0.059	56	8	WWK135D	●
16.5	0/-0.110	10	2.5	-0.032/-0.059	56	8	WWK165B	●
16.5	0/-0.110	10	3	-0.032/-0.059	56	8	WWK165C	●
16.5	0/-0.110	10	4	-0.032/-0.059	56	8	WWK165D	●
16.5	0/-0.110	10	5	-0.032/-0.059	56	8	WWK165E	●
19.5	0/-0.130	10	3	-0.040/-0.073	63	8	WWK195C	●
19.5	0/-0.130	10	4	-0.040/-0.073	63	8	WWK195D	●
19.5	0/-0.130	10	5	-0.040/-0.073	63	8	WWK195E	●
19.5	0/-0.130	10	6	-0.040/-0.073	63	8	WWK195F	●
22.5	0/-0.130	10	4	-0.040/-0.073	63	10	WWK225D	●
22.5	0/-0.130	10	5	-0.040/-0.073	63	10	WWK225E	●
22.5	0/-0.130	10	6	-0.040/-0.073	63	10	WWK225F	●
22.5	0/-0.130	10	8	-0.040/-0.073	63	10	WWK225H	●
25.5	0/-0.130	10	5	-0.040/-0.073	63	10	WWK255E	●
25.5	0/-0.130	10	6	-0.040/-0.073	63	10	WWK255F	●
25.5	0/-0.130	10	7	-0.040/-0.073	63	10	WWK255G	●
25.5	0/-0.130	10	8	-0.040/-0.073	63	10	WWK255H	●
28.5	0/-0.130	10	5	-0.040/-0.073	63	10	WWK285E	●
28.5	0/-0.130	10	6	-0.040/-0.073	63	10	WWK285F	●
28.5	0/-0.130	10	7	-0.040/-0.073	63	10	WWK285G	●
28.5	0/-0.130	10	8	-0.040/-0.073	63	10	WWK285H	●
32.5	0/-0.160	12	5	-0.050/-0.089	71	12	WWK325E	●
32.5	0/-0.160	12	6	-0.050/-0.089	71	12	WWK325F	●
32.5	0/-0.160	12	7	-0.050/-0.089	71	12	WWK325G	●
32.5	0/-0.160	12	8	-0.050/-0.089	71	12	WWK325H	●
32.5	0/-0.160	12	10	-0.050/-0.089	71	12	WWK325L	●

- INFO
- TYPHOON TA-HTA-4HTA
- TYPHOON PU-HPU
- TYPHOON SUH
- TYPHOON ALH
- TYPHOON HRC
- TYPHOON SUH MINI
- TYPHOON HL
- C-SD-TA
- LFTA
- SUTA
- HSS-HSS/CO DRILLS
- G2
- MDTA
- HF VH/UP
- MEF
- ALU
- MEX
- UH
- HSS/CO-HSSP END MILLS
- CARBIDE BURRS

● stock standard ○ non-standard stock ▽ stock exhaustion