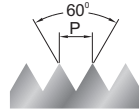
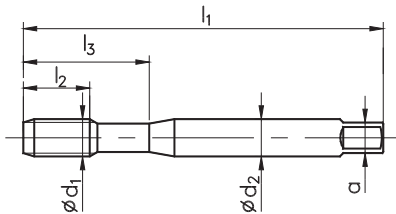
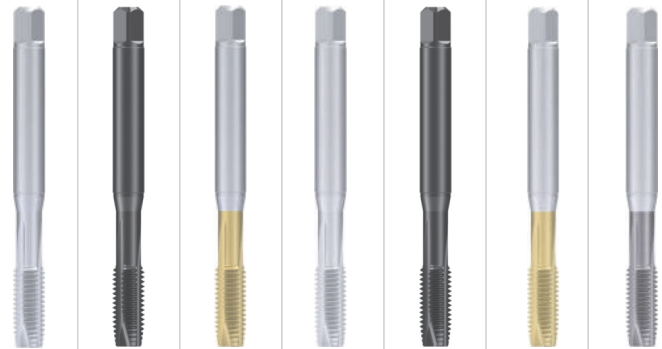

**Gwint metryczny drobnozwojny ISO DIN-13**

 ISO Metric fine thread DIN-13  
 Metrisches ISO-Feingewinde DIN-13

HSSE

**DIN-371**

**Zastosowanie / Application / Einsatzgebiete**
**Materiał obrabiany / Material / Werkstoff**
**Rodzaj materiału / Quality of material / Qualität**
**Typ otworu / Hole type / Lochform**
**Wykonanie / Execution / Ausführung**
**Rodzaj powłoki / Coating / Beschichtung**
**Nakrój / Chamfer / Anschnitt**
**Tolerancja / Tolerance / Toleranz**

|           |            |   |           |            |   |   |
|-----------|------------|---|-----------|------------|---|---|
| 800       | 800        | 800   | INOX      | INOX       | INOX                                    | INOX                                    |
| P1.3      | P1.3, M2.2 | P1.1-P1.4, M2.1<br>M2.2, N4.5, N4.7<br>N4.8 | M2.2      | P1.3, M2.2 | P1.2-1.4, M2.1-M2.2,<br>N4.5, N4.7-N4.8 | P1.2-1.4, M2.1-M2.2,<br>N4.5, N4.7-N4.8 |
| HSSE      | HSSE       | HSSE  | HSSE      | HSSE       | HSSE                                    | HSSE                                    |
|           |            |   |           |            |   |   |
| B         | B          | B   | B         | B          | B                                       | B                                       |
|           | OX         | TiN   |           | OX         | TiN                                     | HL                                      |
| B / 4-5P  | B / 4-5P   | B / 4-5P                                    | B / 4-5P  | B / 4-5P   | B / 4-5P                                | B / 4-5P                                |
| ISO2 (6H) | ISO2 (6H)  | ISO2 (6H)                                   | ISO2 (6H) | ISO2 (6H)  | ISO2 (6H)                               | ISO2 (6H)                               |

| MF<br>Ød <sub>1</sub> | P    | l <sub>1</sub> | l <sub>2</sub> | l <sub>3</sub> | Ød <sub>2</sub> | a   |      | INDEX | C2-111101 | C2-116101 | C2-113101 | C2-111801 | C2-116801 | C2-113801 | C2-118801 |
|-----------------------|------|----------------|----------------|----------------|-----------------|-----|------|-------|-----------|-----------|-----------|-----------|-----------|-----------|-----------|
| M 2,5 x 0,35          | 50   | 50             | 7              | 12             | 2,8             | 2,1 | 2,15 | 0009  |           |           |           |           |           |           |           |
| M 2,6 x 0,35          | 50   | 50             | 7              | 12             | 2,8             | 2,1 | 2,25 | 0008  |           |           |           |           |           |           |           |
| M 3 x 0,35            | 56   | 56             | 8              | 18             | 3,5             | 2,7 | 2,65 | 0031  |           |           |           |           |           |           |           |
| M 3,5 x 0,35          | 56   | 56             | 9              | 20             | 4               | 3   | 3,15 | 0036  |           |           |           |           |           |           |           |
| M 4 x 0,5             | 0,5  | 63             | 10             | 21             | 4,5             | 3,4 | 3,5  | 0041  | ●         | ○         | ○         | ●         | ○         | ○         | ○         |
| M 5 x 0,5             | 0,5  | 70             | 12             | 25             | 6               | 4,9 | 4,5  | 0051  | ●         | ○         | ●         | ●         | ○         | ○         | ○         |
| M 6 x 0,75            | 0,75 | 80             | 14             | 30             | 6               | 4,9 | 5,2  | 0062  | ●         | ●         | ●         | ●         | ○         | ○         | ○         |
| M 8 x 0,75            | 0,75 | 80             | 18             | 30             | 8               | 6,2 | 7,2  | 0082  | ●         | ○         | ○         | ○         | ○         | ○         | ○         |
| M 8 x 1               | 1    | 90             | 20             | 35             | 8               | 6,2 | 7    | 0083  | ●         | ●         | ●         | ●         | ●         | ●         | ●         |
| M 10 x 0,75           | 0,75 | 90             | 20             | 35             | 10              | 8   | 9,2  | 0102  | ●         | ○         | ●         | ●         | ○         | ○         | ○         |
| M 10 x 1              | 1    | 90             | 20             | 35             | 10              | 8   | 9    | 0103  | ●         | ●         | ●         | ●         | ●         | ●         | ●         |
| M 10 x 1,25           | 1,25 | 100            | 20             | 39             | 10              | 8   | 8,8  | 0104  | ●         | ●         | ●         | ●         | ○         | ○         | ○         |

**Preparaty do gwintowania na stronie 243**

 Specimens for threading on 243 page  
 Hilfsmittel für Gewindeschneiden auf der Seite 243

Przykład zamawiania / Example of order / Beispiel einer Bestellung:

 C2-113101-0103  
 DIN-371 B M10x1 ISO2 HSSE 800 TiN

● Dostępne z magazynu, cena w cenniku

Available from stock, the price in the price list / Ab Lager lieferbar, der Preis in der Preisliste

○ Do szybkiej dostawy, cena na zapytanie

For quick delivery, price on request / Für die schnelle Lieferung, Preis auf Anfrage