

1

Whitworth pipe thread Rp, PN-ISO 7/1,
DIN EN 10226-1

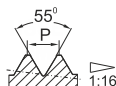

Tapere Whitworth pipe thread Rc, PN-ISO 7/1,
DIN EN 10226-2

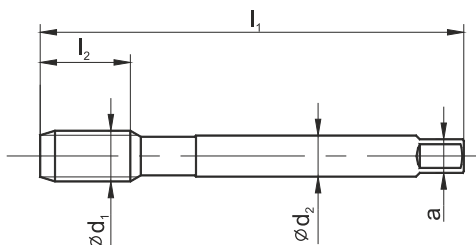

HSSE

DIN
5156DIN
~5156

800

c

c



Material groups



Hole type

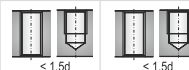

Quality of material

HSSE

HSSE

Coating

Chamfer

C / 2-3P

C / 2-3P

Rp	Ød ₁	1"/P	P	l ₁	l ₂	l ₃	Ød ₂	a		Norm			
										DIN-5156			
										Tol.			
										INDEX	D2-121101		
Rp-1/16"	7,723	28	0,907	90	17	-	6,0	4,9	6,55	3221	o		
Rp-1/8"	9,728	28	0,907	90	18	-	7,0	5,5	8,60	3223	o		
Rp-1/4"	13,157	19	1,337	100	22	-	11,0	9,0	11,50	3227	o		
Rp-3/8"	16,662	19	1,337	100	22	-	12,0	9,0	15,00	3229	o		
Rp-1/2"	20,955	14	1,814	125	25	-	16,0	12,0	18,50	3231	o		
Rp-3/4"	26,441	14	1,814	140	28	-	20,0	16,0	24,00	3235	o		
Rp-1"	33,249	11	2,309	160	32	-	25,0	20,0	30,25	3239	o		

Rc	Ød ₁	1"/P	P	l ₁	l ₂	l ₃	Ød ₂	a		Norm	~DIN-5156		
										Tol.			
										INDEX	D2-121101		
Rc-1/16"	-	28	0,907	90	17	-	6,0	4,9	6,15	3321	o		
Rc-1/8"	-	28	0,907	90	18	-	7,0	5,5	8,15	3323	•		
Rc-1/4"	-	19	1,337	100	22	-	11,0	9,0	10,85	3327	•		
Rc-3/8"	-	19	1,337	100	22	-	12,0	9,0	14,30	3329	•		
Rc-1/2"	-	14	1,814	125	25	-	16,0	12,0	17,80	3331	o		
Rc-3/4"	-	14	1,814	140	28	-	20,0	16,0	23,20	3335	o		
Rc-1"	-	11	2,309	160	33	-	25,0	20,0	29,20	3339	o		

Conical reamer 1:16 on page 157



ISO	V _c (m/min)			
P	5-20	5-20		
M	-	-		
K	5-15	5-15		
N	10-25	10-25		
S	-	-		

Information concerning imensioins of the holes for tapere threads in the technical part of the catalogue on page 269

