

ISO Metric coarse thread DIN-13

INOX



HSSE

HL

DIN 376

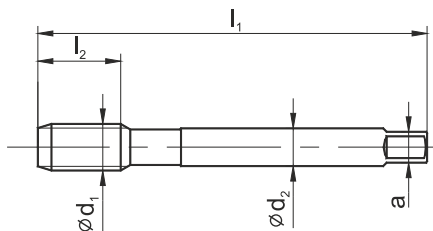

Material groups

P	M	K	P	M	K	P	M	K	P	M	K
N	S	H	N	S	H	N	S	H	N	S	H

Hole type



Quality of material

HSSE HSSE HSSE HSSE

Coating

- HL - HL

Chamfer

B / 4-5P B / 4-5P C / 2-3P C / 2-3P

M Ød ₁	P	l ₁	l ₂	l ₂ R40	l ₃	Ød ₂	a		DIN-376							
									Norm							
									Tol.	ISO2 (6H)	ISO2 (6H)	ISO2 (6H)	ISO2 (6H)			
									INDEX	D2-111801	D2-118801	D2-511801	D2-518801			
M8	1,25	90	20	15	-	6,0	4,9	6,80	0080	●	●	●	●			
M10	1,50	100	20	17	-	7,0	5,5	8,50	0100	●	●	●	●			
M12	1,75	110	24	18	-	9,0	7,0	10,20	0120	●	●	●	●			
M14	2,00	110	25	20	-	11,0	9,0	12,00	0140	●	●	●	●			
M16	2,00	110	32	20	-	12,0	9,0	14,00	0160	●	●	●	●			
M18	2,50	125	32	25	-	14,0	11,0	15,50	0180	●	●	●	●			
M20	2,50	140	32	25	-	16,0	12,0	17,50	0200	●	●	●	●			
M22	2,50	140	32	25	-	18,0	14,5	19,50	0220	●	●	●	●			
M24	3,00	160	38	30	-	18,0	14,5	21,00	0240	●	●	●	●			
M27	3,00	160	38	30	-	20,0	16,0	24,00	0270	●	○	●	○			
M30	3,50	180	40	35	-	22,0	18,0	26,50	0300	●	○	●	○			
M33	3,50	180	45	35	-	25,0	20,0	29,50	0330	●	○	●	○			
M36	4,00	200	50	40	-	28,0	22,0	32,00	0360	●	○	●	○			

ISO	V _c (m/min)			
P	-	-	-	-
M	5-15	5-15	5-15	5-15
K	-	-	-	-
N	-	-	-	-
S	-	-	-	-