

No. 6415

Height setting screw jack

with 2 locating pins DIN 6325 (12x50 and 12x80). Centring hole dia. 12 mm. Tempering steel, blued. Spindle: M30x1.5 metric fine thread with end stopbody. Bearing insert turns on pressed-in plain bearing bush.



Order no.	Size	H min.	H max.	D1	D2	with location pin 12x50 H1min.-H1max.	with location pin 12x80 H1min.-H1max.	F max. [kN]	Weight [g]
86504	75	55	75	50	36	83-103	113-133	30	680
86512	115	75	115	50	36	103-143	133-173	30	880

Application:

The height setting screw jack can be used without locating pins or with pads no. 6440 and no. 6441. With centering pad no. 6242 combinations with all AMF-screw jacks are possible. They allow sensitive adjusting up to height of 1370 mm. A bearing insert prevents the workpiece from being turned while the jack is adjusted.

Note:

Suitable pads are no. 6440, 6441, 6442. Suitable base is no. 6442.

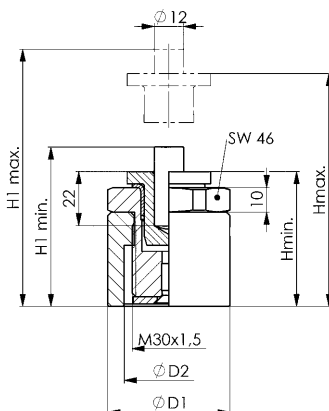

Recommendations



No. 6440,
page 56



No. 6441,
page 56



No. 6442,
page 56

CAD



No. 6416

Height setting screw jack with magnetic base

with 2 locating pins DIN 6325 (12x50 and 12x80). Centring hole dia. 12 mm. Tempering steel, blued. Spindle: M30x1.5 metric fine thread with end stopbody. Bearing insert turns on pressed-in plain bearing bush.



Order no.	Size	H min.	H max.	D1	with location pin 12x50 H1min.-H1max.	with location pin 12x80 H1min.-H1max.	F max. [kN]	Weight [g]
86520	85	65	85	50	93-113	123-143	30	800
86538	125	85	125	50	113-153	143-183	30	1000

Application:

The height setting screw jack can be used without locating pins or with pads no. 6440 and no. 6441. With centering pad no. 6242 combinations with all AMF-screw jacks are possible. They allow sensitive adjusting up to height of 1370 mm. A bearing insert prevents the workpiece from being turned while the jack is adjusted.

Note:

Suitable pads are no. 6440, 6441, 6442.

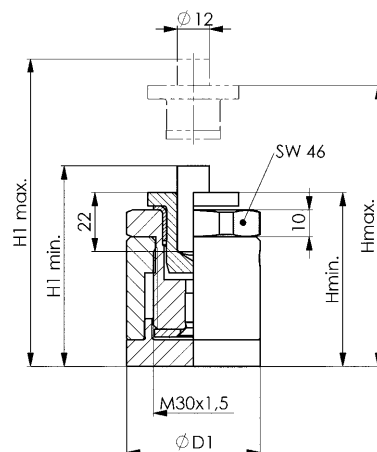

Recommendations



No. 6315GN,
page 22



No. 6315GNG,
page 22

CAD



Subject to technical alterations.