

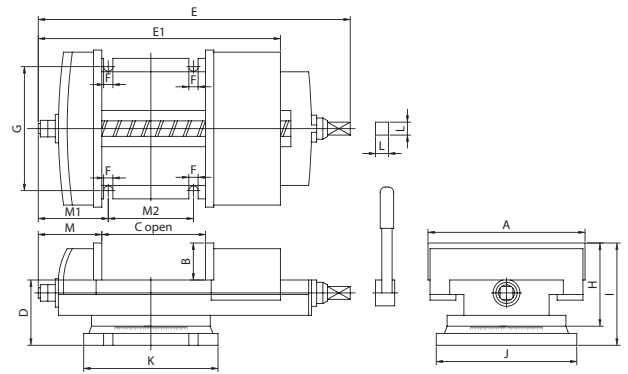

Machine Vise For Shaping & Milling Use



The vise is made of the high tension cast iron, rigidity, large range of clamping spans and more bigger clamping force at press down jaws, especially suitable for the heavy duty cutting and the heavy duty planer milling machine to clamp large workpiece.

Unit:mm

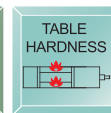

ORDER NO.	A	B	C OPEN	D	E	E1	F	G	H	I	J	K	L	M	M1	M2	Max. Clamp Force (kgf)	G.W. (kgs)	CUFT (cm)	CODE NO.
VSM-12	304	72	290	126	604	560	18	240	161	198	272	260	25	123	135	165	800	84	67x35x23	1002-270
VSM-16	405	96	415	145	763	738	20	292	200	241	336	336	25	135	143	248	1000	142	84x45x27	1002-271
VSM-20	508	95	505	150	902	871	21	288	204	245	336	336	25	169	211	246	1200	200	97x56x28	1002-272



B-Type Milling Vise

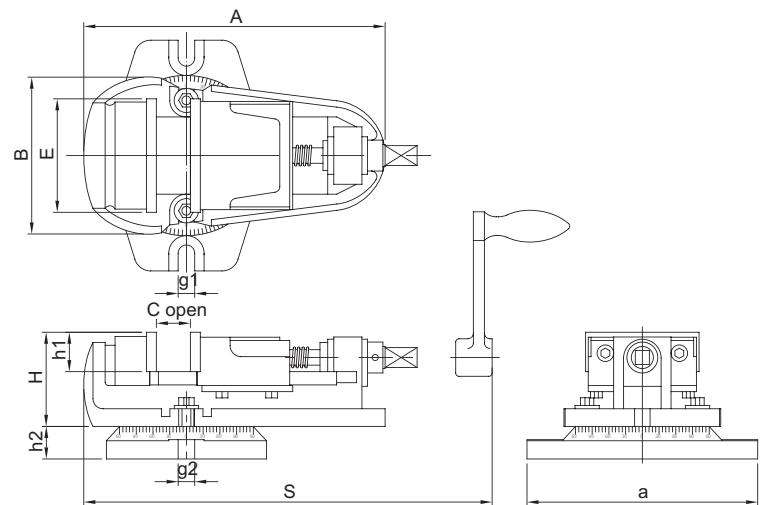
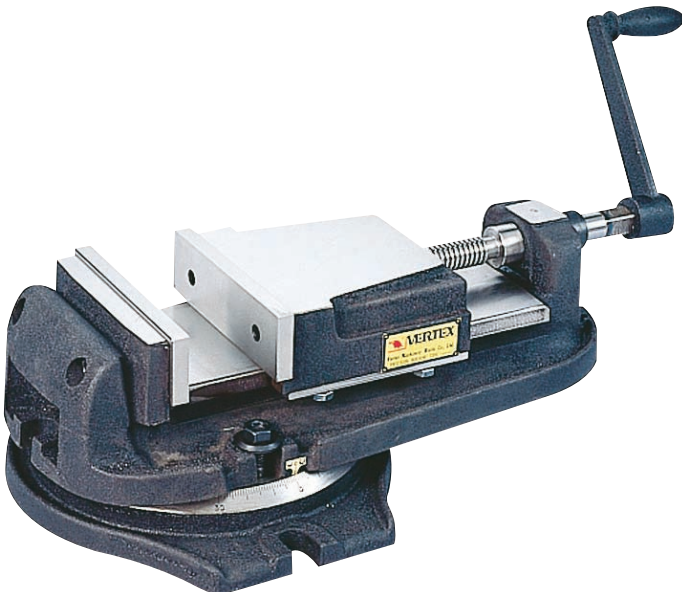

- A wider bottom to increase clamping force.
- Groove device to collect cutting oil.
- Full 360° swivel base with line, accurate graduation.
- In order to ensure the accuracy when using it better that don't put swivel base together

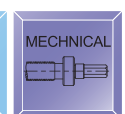
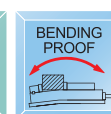
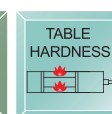

ORDER NO.	A	B	E	H	C OPEN	S	a	h1	h2	g1	g2	Max. Clamp Force (kgf)	G.W. kgs	CODE NO.
VBV-4	270	140	100	79	65	305	212	33	28	12	12	900	13	1002-280
VBV-5	350	180	125	96	100	410	280	37	35	15	15	900	21.5	1002-281
VBV-6	452	218	160	103	132	483	317	48	40	16	16	1000	41	1002-282