



CC-12, Ø105
BIG THROUGH HOLE DESIGN



CC-8



Masking Plate

※ When order optional higher accuracy chuck , price will be higher.

- The center through hole is big to be suitable for the large and long workpiece.
- Hardened and ground 24 position master plate, can index the special angle of 15 with excellent accuracy.
- CS-Type can be used with 2 pcs type 3-Jaw Chuck. Especially, it does similar work. as rotary table when it match with face plate.
- Rapid indexing and easy operation. It's a sharp equipment for mass-production.
- Simple index include 3-jaw chuck, Masking Plates 2, 3, 4, 6, 8, 12
- Used the key guide block, the center can be corrected quickly and accurately.
- CC-6 with VSK-6A chuck front fixing hole type.
- CC-8 with VSK-8A chuck front fixing hole type.
- CC-12 with VSK-12 chuck front fixing hole type.
- CC-12A with VSK-12A chuck economical chuck.

CS-6 with VSK-6A chuck front fixing hole type.
CS-8 with VSK-8A chuck front fixing hole type.

FIG. (I) CC-6, 8

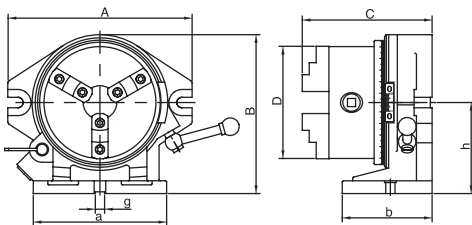
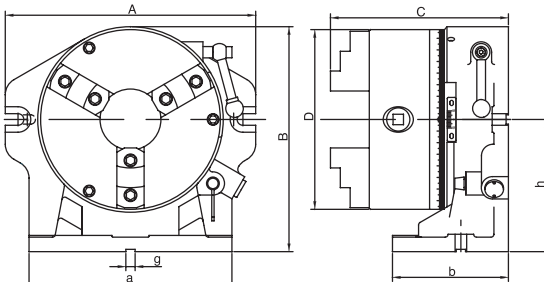

FIG. (II) CC-12



STANDARDS OF ACCURACY for Simple Index for Super-Dex.		
NO.	Testing Objective	Tolerances Per 100mm Permitted Max.
1	Parallelism of table surface to base	0.02
2	True running of axial movement of table surface	0.03
3	True running of center boss	0.02
4	Squareness of base to angle face	0.02

Optional Accessories

Tailstock

TS-2 FOR CC-6
TS-3 FOR CC-8
TS-4 FOR CC-12
please see page A3



Unit:mm

Specifications

ORDER NO.	Fig.	Dividual number	A	B	C	D	a	b	h	Inner jaw	g	Outer jaw	Diameter of hole (turret)	Diameter of hole (chuck)	Gross weight kgs	Meas. CFT	CODE NO.
CC-6	I	2, 3, 4, 6	253	225	179	160	187	115	130	Ø55~Ø145	16	Ø3~Ø160	44	44	(C)29.5	0.9	1001-062
CC-8	II	8, 12, 24	318	274	209	200	230	155	157	Ø65~Ø200	16	Ø4~Ø200	63	58	(C)51.5	1.3	1001-063
CC-12	II	2, 3, 4, 6	432	388	293	315	350	200	228	Ø100~Ø315	16	Ø10~Ø315	106	105	(W)163	3.6	1001-066
NEW CC-12A	II	8, 12, 16, 24, 48															1001-066A